



**NO SHOULDER
MILLING AND
RESURFACING
FOR ALL
LOCATIONS
EXCEPT
FALKENBURG
ROAD RAMPS**

WEUCID AVE

WB SELMON EXPY

EB SELMON EXPY

END M&R
AT PAVEMENT JOINT

O-01221
EUCLID EB ON RAMP TO SELMON EXPY LANE
1.5" MILLING AND RESURFACING
1226 SY

BEGIN M&R
AT PAVEMENT JOINT

S DREXEL AVE

S WAVERLY CIRCLE



WB SELMON EXPY

EB SELMON EXPY

BAY TO BAY BLVD

BEGIN M&R
AT PAVEMENT JOINT

O-01221
BAY TO BAY EB ON RAMP TO SELMON EXPY LANE
1.5" MILLING AND RESURFACING
1133 SY

END M&R
AT PAVEMENT JOINT



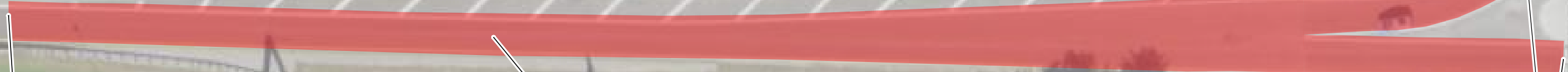

BEGIN M&R
AT PAVEMENT JOINT

O-01221
50TH ST WB ON RAMP TO SELMON EXPY LANE
1.5" MILLING AND RESURFACING
1839 SY

END M&R
AT CROSSWALKS

WB SELMON EXPY

SELMON EXPY REVERSIBLE LANES

EB SELMON EXPY



BEGIN M&R AT
PAVEMENT JOINT
TO ROUGH PATCH

SELMON EXPY REVERSIBLE LANES

END M&R 100 FEET
EAST OF START POINT

WB SELMON EXPY

O-01221
WB SELMON EXPY LOCAL LANES FROM PAVEMENT JOINT
TO POINT 100 FEET EAST
3" MILLING AND RESURFACING
283 SY

EB SELMON EXPY

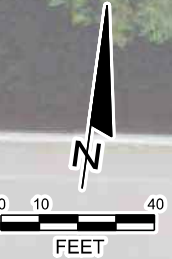

O-01221
WB SELMON EXPY LOCAL LANES
RESURFACE WB ROADWAY TRAVEL LANES 50 FEET WEST
AND 50 FEET EAST OF CENTER OF EXISTING PATCH LOCATED
APPROXIMATELY AT PIER 97



100 FT

O-01221
WB SELMON EXPY LOCAL LANES
3" MILLING AND RESURFACING
435 SY

SELMON EXPY REVERSIBLE LANES

WB SELMON EXPY

EB SELMON EXPY



An aerial photograph of a highway interchange. The highway has multiple lanes, with reversible express lanes on the right side. A red callout box with white text points to a specific area on the road. The surrounding area includes a grassy field on the left, a wooded area in the center, and a large industrial yard with many colorful shipping containers and trucks on the right. A north arrow is visible in the bottom right corner.

Resurface WB Roadway travel lanes below the Reversible Express Lanes 50 feet west and 50 feet east of center of existing patch located approximately at Pier 97

Straddle Bent Pier No. 97

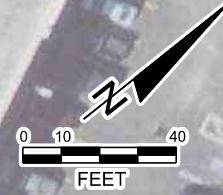

WEST

BEGIN M&R
AT STOP BAR

END M&R
AT PAVEMENT JOINT

E KENNEDY BLVD

O-01321
KENNEDY WB OFF RAMP LANE
3" MILLING AND RESURFACING
TOP 1.5" TO BE HI-POLYMER
946 SY

WB SELMON EXPY

EB SELMON EXPY

N GOVERNOR ST

E KENNEDY BLVD



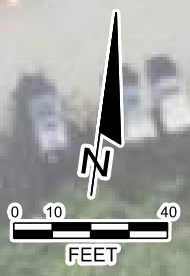

WB SELMON EXPY

SELMON EXPY REVERSIBLE LANES

EB SELMON EXPY

O-01321
EB SELMON EXPY LOCAL LANES FROM PIER 65 TO MAYDELL BRIDGE APPROACH SLAB
3" MILLING AND RESURFACING
4288 SY

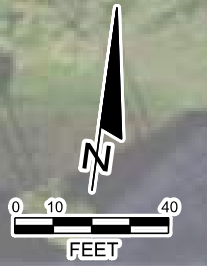

WB SELMON EXPY

SELMON EXPY REVERSIBLE LANES

EB SELMON EXPY

END M&R
AT PAVEMENT JOINT

O-01321
EB SELMON EXPY LOCAL LANES FROM PIER 65 TO MAYDELL BRIDGE APPROACH SLAB
3" MILLING AND RESURFACING
4288 SY

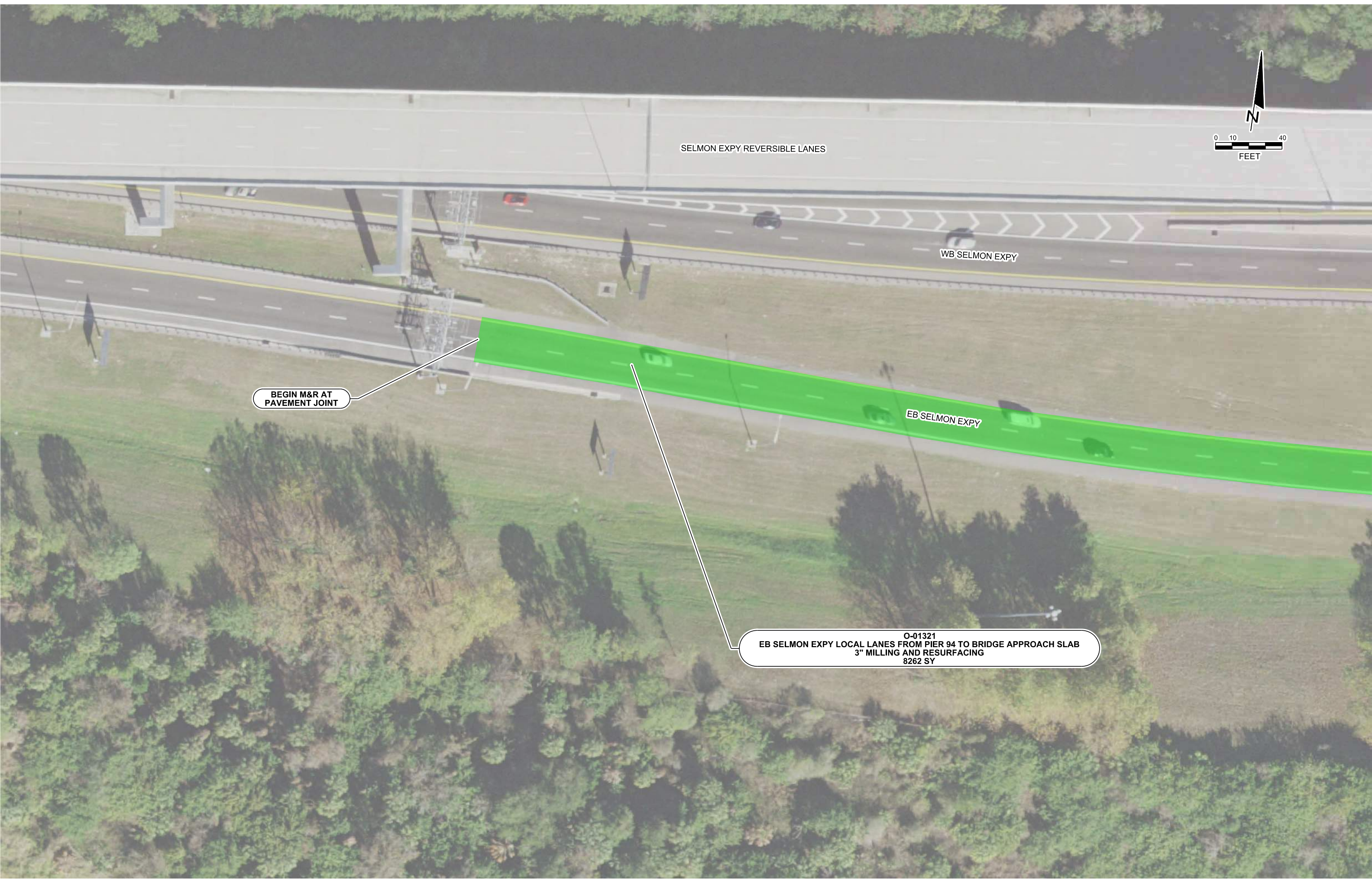

SELMON EXPY REVERSIBLE LANES

WB SELMON EXPY

EB SELMON EXPY

BEGIN M&R AT PAVEMENT JOINT

O-01321
EB SELMON EXPY LOCAL LANES FROM PIER 94 TO BRIDGE APPROACH SLAB
3" MILLING AND RESURFACING
8262 SY

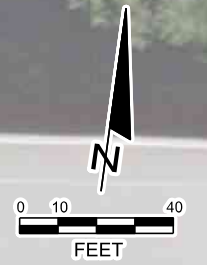

SELMON EXPY REVERSIBLE LANES

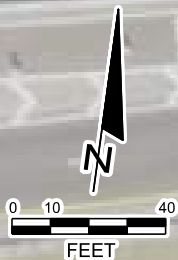

WB SELMON EXPY

EB SELMON EXPY

O-01321
EB SELMON EXPY LOCAL LANES FROM PIER 94 TO BRIDGE APPROACH SLAB
3" MILLING AND RESURFACING
8262 SY

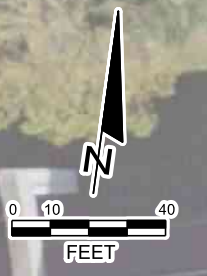

SELMON EXPY REVERSIBLE LANES

WB SELMON EXPY

EB SELMON EXPY



O-01321
EB SELMON EXPY LOCAL LANES FROM PIER 94 TO CANAL OVERPASS LANES
1.5" MILLING AND RESURFACING
8262 SY (713 TN)

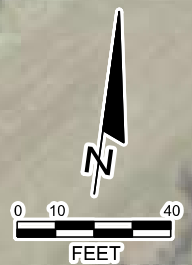

WB SELMON EXPY

SELMON EXPY REVERSIBLE LANES

EB SELMON EXPY

END M&R AT PAVEMENT JOINT

O-01321
EB SELMON EXPY LOCAL LANES FROM PIER 94 TO BRIDGE APPROACH SLAB
3" MILLING AND RESURFACING
8262 SY





SB 78TH ST

NB 78TH ST

BEGIN M&R AT PAVEMENT JOINT

END M&R AT PAVEMENT JOINT

O-01321
78TH ST WB ON RAMP FROM SR 60 LANE
1.5" MILLING AND RESURFACING
1250 SY

O-01321
78TH ST WB ON RAMP LANE
3" MILLING AND RESURFACING
TOP 1.5" TO BE HI-POLYMER
2940 SY

WB SELMON EXPY

SELMON EXPY REVERSIBLE LANES

EB SELMON EXPY



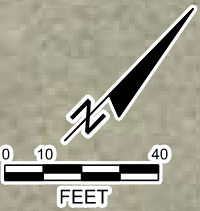

WB SR60

EB SR60

END M&R AT
PAVEMENT JOINT

O-01321
78TH ST WB ON RAMP FROM SR 60 LANE
1.5" MILLING AND RESURFACING
1250 SY



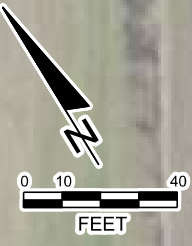

NB 78TH ST
SB 78TH ST

BEGIN M&R AT
PAVEMENT JOINT

O-01321
78TH ST OFF RAMP EB LANE
1.5" MILLING AND RESURFACING
289 SY

END M&R AT
PAVEMENT JOINT





US301 N ON RAMP TO WB SELMON EXPY

WB SELMON EXPY

SELMON EXPY REVERSIBLE LANES

EB SELMON EXPY

EB SELMON EXPY
EXIT TO US 301

BEGIN M&R AT
PAINTED GORE

O-01321
EB OFF EXIT TO US 301 LANE
1.5" MILLING AND RESURFACING
489 SY

END M&R AT
END OF GORE

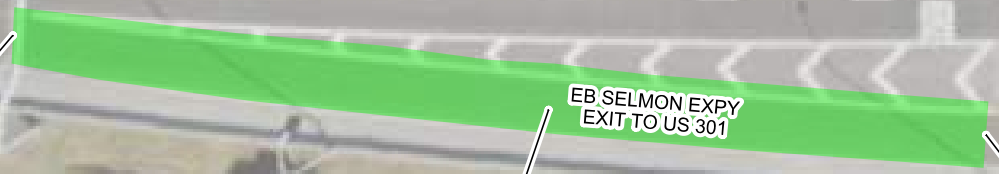

**NO SHOULDER
MILLING AND
RESURFACING
FOR ALL
LOCATIONS
EXCEPT
FALKENBURG
ROAD RAMPS**

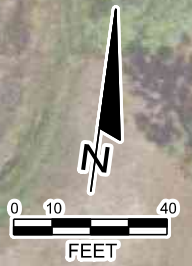

O-01321
FALKENBURG WB ON RAMP LANE AND SHOULDERS
1.5" MILLING AND RESURFACING
3113 SY

BEGIN M&R AT
END OF GORE

S FALKENBURG RD ON RAMP TO WB SELMON EXPY

WB SELMON EXPY

SELMON EXPY REVERSIBLE LANES

EB SELMON EXPY



**NO SHOULDER
MILLING AND
RESURFACING
FOR ALL
LOCATIONS
EXCEPT
FALKENBURG
ROAD RAMPS**

END M&R AT
PAVEMENT JOINT

O-01321
FALKENBURG WB ON RAMP LANE AND SHOULDERS
1.5" MILLING AND RESURFACING
3113 SY

END M&R AT
PAVEMENT JOINT

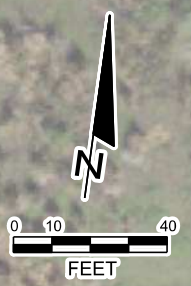

SB FALKENBURG RD

NB FALKENBURG RD

WB SELMON EXPY

BETWEEN HIMES AND EUCLID AVENUES (1)

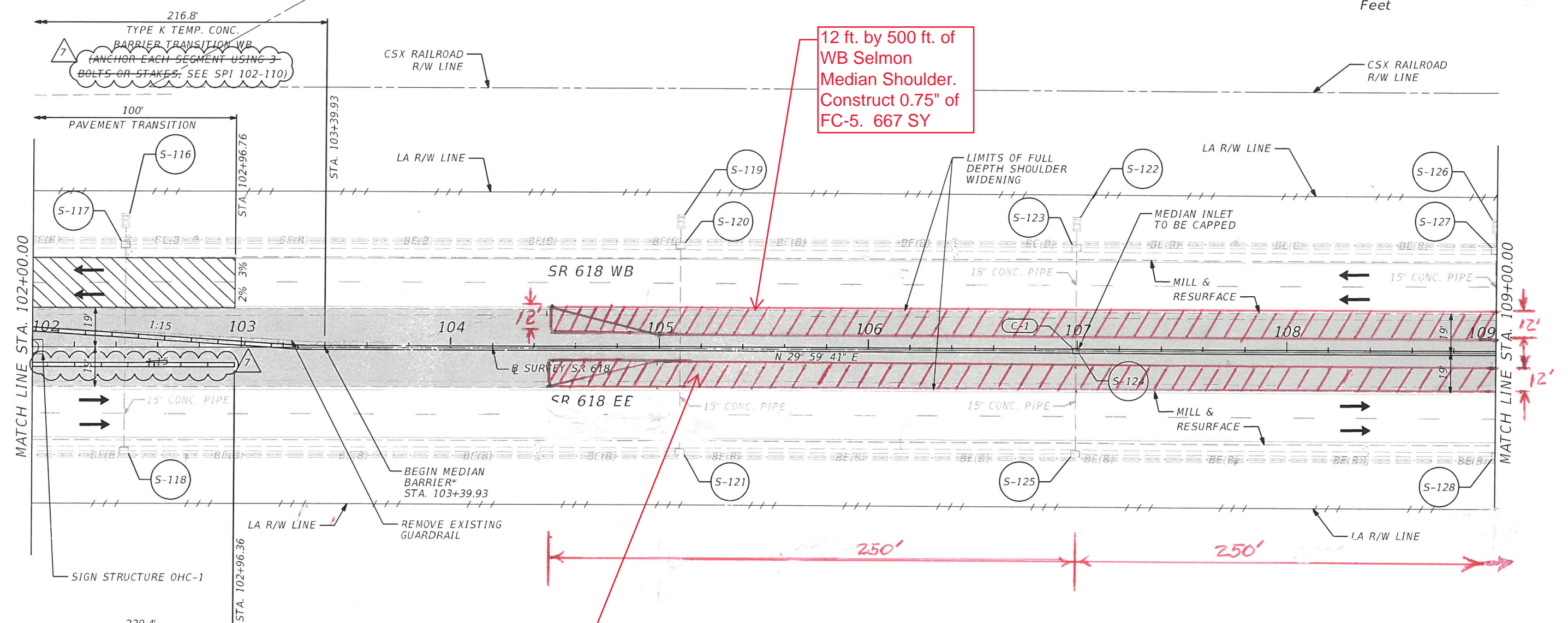
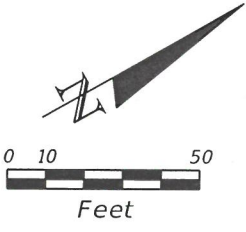

12 ft. by 500 ft. of
WB Selmon
Median Shoulder.
Construct 0.75" of
FC-5. 667 SY

12 ft. by 500 ft. of
EB Selmon Median
Shoulder.
Construct 0.75" of
FC-5. 667 SY

TYPE K TEMP. CONC. BARRIER TRANSITION WB (ANCHOR EACH SEGMENT USING 3 BOLTS OR STAKES, SEE SPI 102-110)

- LEGEND**
- DENOTES WIDENING
 - DENOTES PAVE. TRANS.
 - DENOTES MISC. PAVT.
 - DENOTES DIRECTION OF TRAFFIC
 - XX EXISTING DRAINAGE
 - XX PROPOSED STRUCTURE

NOTE:
*SHORT GRADE-SEPARATED SECTION
SPI 521-001 (SHEET 5 OF 21)

REVISIONS		BRIAN J. FLYNN, P.E. P.E. LICENSE NO. 48071 PARSONS TRANSPORTATION GROUP INC. 5100 W. LEMON STREET, SUITE 145 TAMPA, FL 33609 PHONE: (813) 933-3820 CERTIFICATE OF AUTHORIZATION NO. 1838		TAMPA HILLSBOROUGH EXPRESSWAY AUTHORITY		ROADWAY PLAN	SHEET NO. 36
DATE	DESCRIPTION	DATE	DESCRIPTION	ROAD NO.	COUNTY		
10/23/20	AS-BUILT			SR 618	HILLSBOROUGH	O-00518	

THE OFFICIAL RECORD OF THIS SHEET IS THE ELECTRONIC FILE DIGITALLY SIGNED AND SEALED UNDER RULE 61G15-23.004, F.A.C.

BETWEEN HIMES AND EUCLID AVENUES (2)

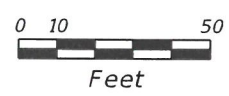
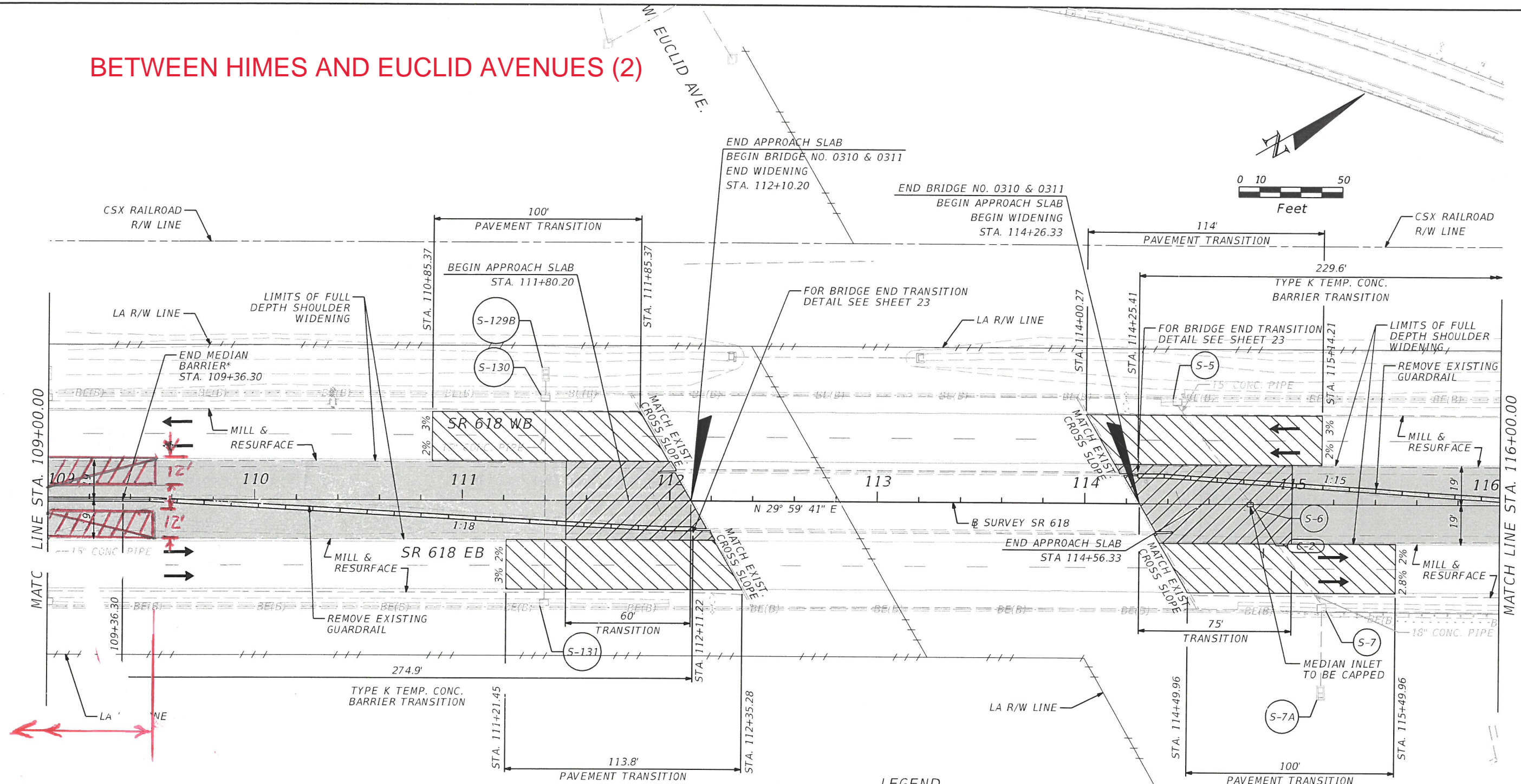

- LEGEND**
- DENOTES WIDENING
 - DENOTES PAVE. TRANS.
 - DENOTES MISC. PAVT.
 - DENOTES DIRECTION OF TRAFFIC
 - XX EXISTING DRAINAGE
 - XX PROPOSED STRUCTURE

NOTE:
 *SHORT GRADE-SEPARATED SECTION
 SPI 521-001 (SHEET 5 OF 21)

REVISIONS			
DATE	DESCRIPTION	DATE	DESCRIPTION

BRIAN J. FLYNN, P.E.
 P.E. LICENSE NO. 48071
 PARSONS TRANSPORTATION GROUP INC.
 5100 W. LEMON STREET, SUITE 145
 TAMPA, FL 33609
 PHONE: (813) 933-3820
 CERTIFICATE OF AUTHORIZATION NO. 1838

TAMPA HILLSBOROUGH EXPRESSWAY AUTHORITY		
ROAD NO.	COUNTY	THEA PROJECT #
SR 618	HILLSBOROUGH	O-00518

ROADWAY PLAN

SHEET NO.
37

THE OFFICIAL RECORD OF THIS SHEET IS THE ELECTRONIC FILE DIGITALLY SIGNED AND SEALED UNDER RULE 61G15-23.004, F.A.C.

MISSISSIPPI AVENUE TO S. HOWARD AVENUE (1)

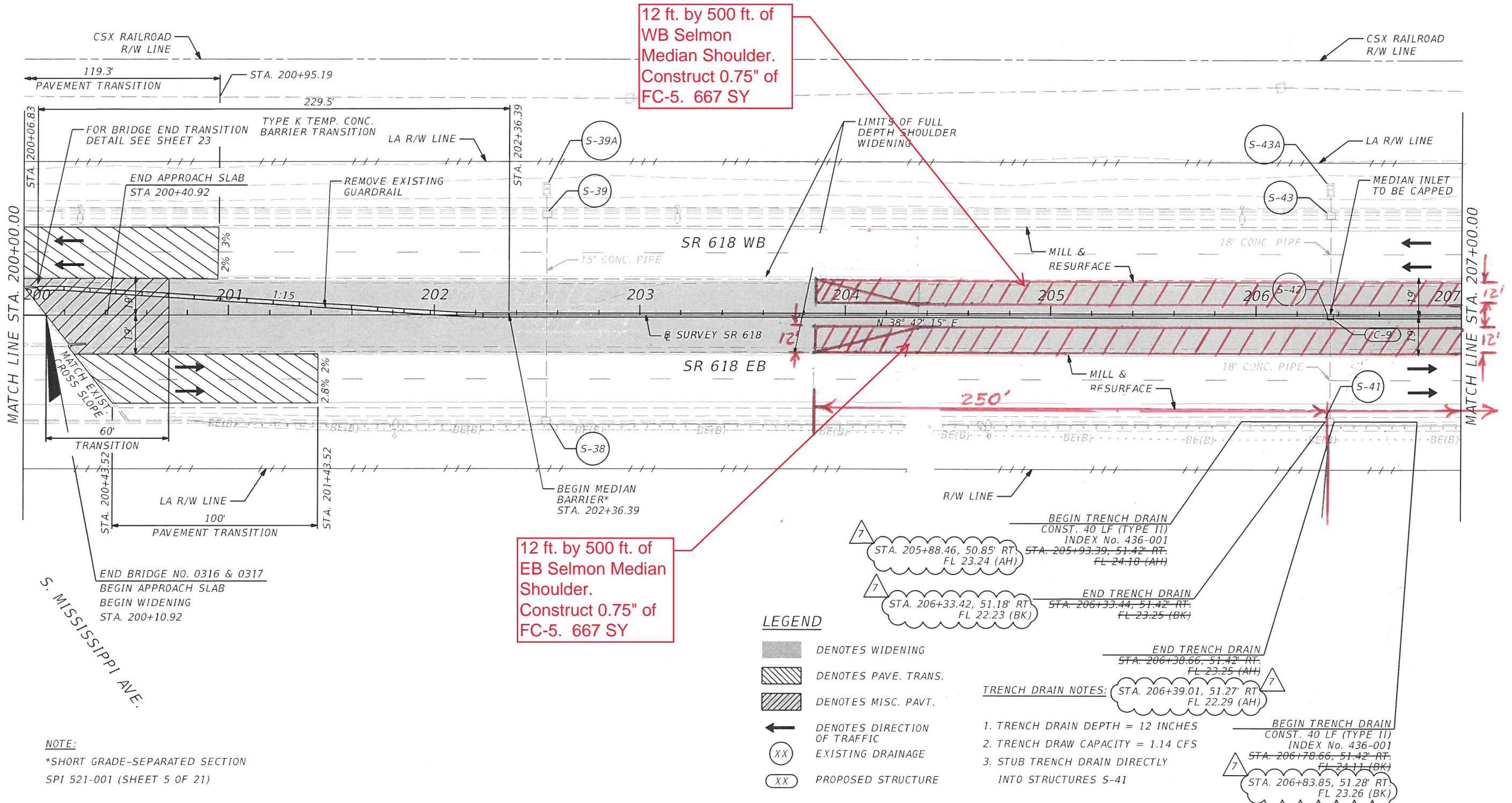
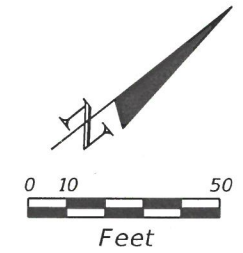

NOTE:
*SHORT GRADE-SEPARATED SECTION
SPI 521-001 (SHEET 5 OF 21)

LEGEND

- DENOTES WIDENING
- DENOTES PAVE. TRANS.
- DENOTES MISC. PAVT.
- DENOTES DIRECTION OF TRAFFIC
- EXISTING DRAINAGE
- PROPOSED STRUCTURE

TRENCH DRAIN NOTES:

1. TRENCH DRAIN DEPTH = 12 INCHES
2. TRENCH DRAIN CAPACITY = 1.14 CFS
3. STUB TRENCH DRAIN DIRECTLY INTO STRUCTURES S-41

BEGIN TRENCH DRAIN
CONST. 40 LF (TYPE II)
INDEX No. 436-001
STA. 205+88.46, 50.85' RT. FL 23.24 (AH)
STA. 205+93.39, 51.42' RT. FL 24.18 (AH)

END TRENCH DRAIN
STA. 206+33.42, 51.18' RT. FL 22.23 (BK)
STA. 206+33.44, 51.42' RT. FL 23.25 (BK)

END TRENCH DRAIN
STA. 206+38.66, 51.42' RT. FL 23.25 (AH)

BEGIN TRENCH DRAIN
CONST. 40 LF (TYPE II)
INDEX No. 436-001
STA. 206+78.66, 51.42' RT. FL 24.11 (BK)
STA. 206+83.85, 51.28' RT. FL 23.26 (BK)

REVISIONS		DESCRIPTION		BRIAN J. FLYNN, P.E. P.E. LICENSE NO. 48071 PARSONS TRANSPORTATION GROUP INC. 5100 W. LEMON STREET, SUITE 145 TAMPA, FL 33609 PHONE: (813) 933-3820 CERTIFICATE OF AUTHORIZATION NO. 1838	TAMPA HILLSBOROUGH EXPRESSWAY AUTHORITY			ROADWAY PLAN	SHEET NO. 50
DATE	DESCRIPTION	DATE	DESCRIPTION		ROAD NO.	COUNTY	THEA PROJECT #		
10/23/20	AS-BUILT				SR 618	HILLSBOROUGH	O-00518		

THE OFFICIAL RECORD OF THIS SHEET IS THE ELECTRONIC FILE DIGITALLY SIGNED AND SEALED UNDER RULE 61G15-23.004, F.A.C.

MISSISSIPPI AVENUE TO S. HOWARD AVENUE (2)

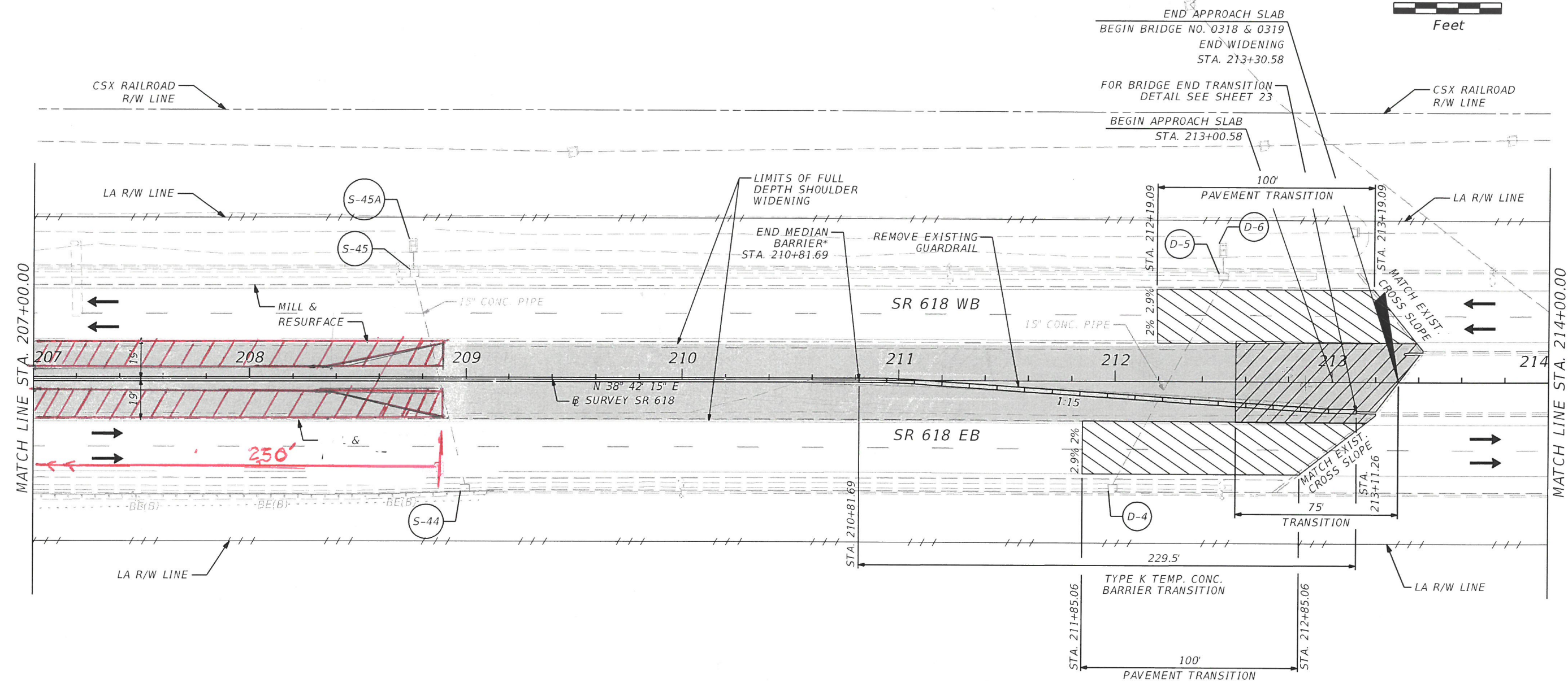
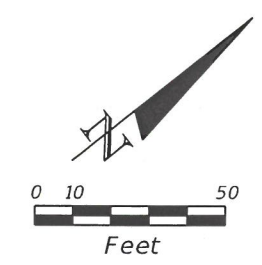

- LEGEND**
- DENOTES WIDENING
 - DENOTES PAVE. TRANS.
 - DENOTES MISC. PAVT.
 - DENOTES DIRECTION OF TRAFFIC
 - EXISTING DRAINAGE
 - PROPOSED STRUCTURE

NOTE:
 *SHORT GRADE-SEPARATED SECTION
 SPI 521-001 (SHEET 5 OF 21)

REVISIONS				BRIAN J. FLYNN, P.E. P.E. LICENSE NO. 48071 PARSONS TRANSPORTATION GROUP INC. 5100 W. LEMON STREET, SUITE 145 TAMPA, FL 33609 PHONE: (813) 933-3820 CERTIFICATE OF AUTHORIZATION NO. 1838	TAMPA HILLSBOROUGH EXPRESSWAY AUTHORITY			ROADWAY PLAN	SHEET NO.
DATE	DESCRIPTION	DATE	DESCRIPTION		ROAD NO.	COUNTY	THEA PROJECT #		51
						SR 618	HILLSBOROUGH		O-00518

THE OFFICIAL RECORD OF THIS SHEET IS THE ELECTRONIC FILE DIGITALLY SIGNED AND SEALED UNDER RULE 61G15-23.004, F.A.C.

MORRISON AVENUE TO SWANN AVENUE

@ SURVEY SR 618.14
 PI STA. = 236+72.15
 Δ = 3° 00' 25" (LT.)
 D = 0° 29' 56"
 T = 301.43
 L = 602.71
 R = 11,484.19
 PC STA. = 233+70.72
 PT STA. = 239+73.44
 e = NC

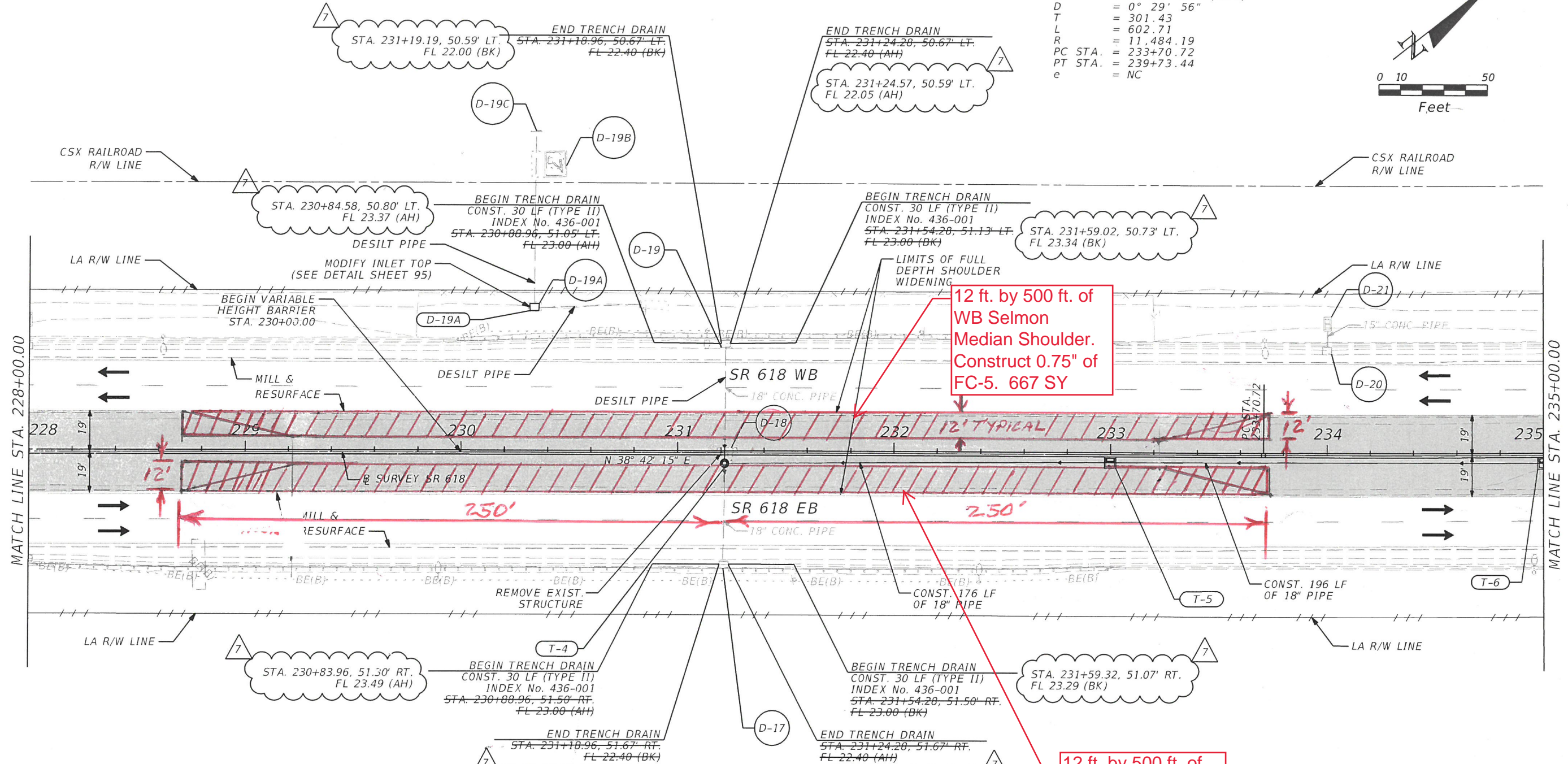
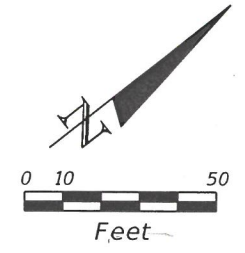

- TRENCH DRAIN NOTES:**
1. TRENCH DRAIN DEPTH = 12 INCHES
 2. TRENCH DRAW CAPACITY = 1.14 CFS
 3. STUB TRENCH DRAIN DIRECTLY INTO STRUCTURES D-17 & D-19

12 ft. by 500 ft. of EB Selmon Median Shoulder.
 Construct 0.75" of FC-5. 667 SY

- LEGEND**
- DENOTES WIDENING
 - DENOTES PAVE. TRANS.
 - DENOTES MISC. PAVT.
 - DENOTES DIRECTION OF TRAFFIC
 - EXISTING DRAINAGE
 - PROPOSED STRUCTURE

REVISIONS		BRIAN J. FLYNN, P.E.		TAMPA HILLSBOROUGH EXPRESSWAY AUTHORITY		SHEET NO.
DATE	DESCRIPTION	DATE	DESCRIPTION	ROAD NO.	COUNTY	
10/23/20	AS-BUILT			SR 618	HILLSBOROUGH	54
					THEA PROJECT #	
					0-00518	

THE OFFICIAL RECORD OF THIS SHEET IS THE ELECTRONIC FILE DIGITALLY SIGNED AND SEALED UNDER RULE 61G15-23.004, F.A.C.

SWANN AVENUE TO PLATT STREET (1)

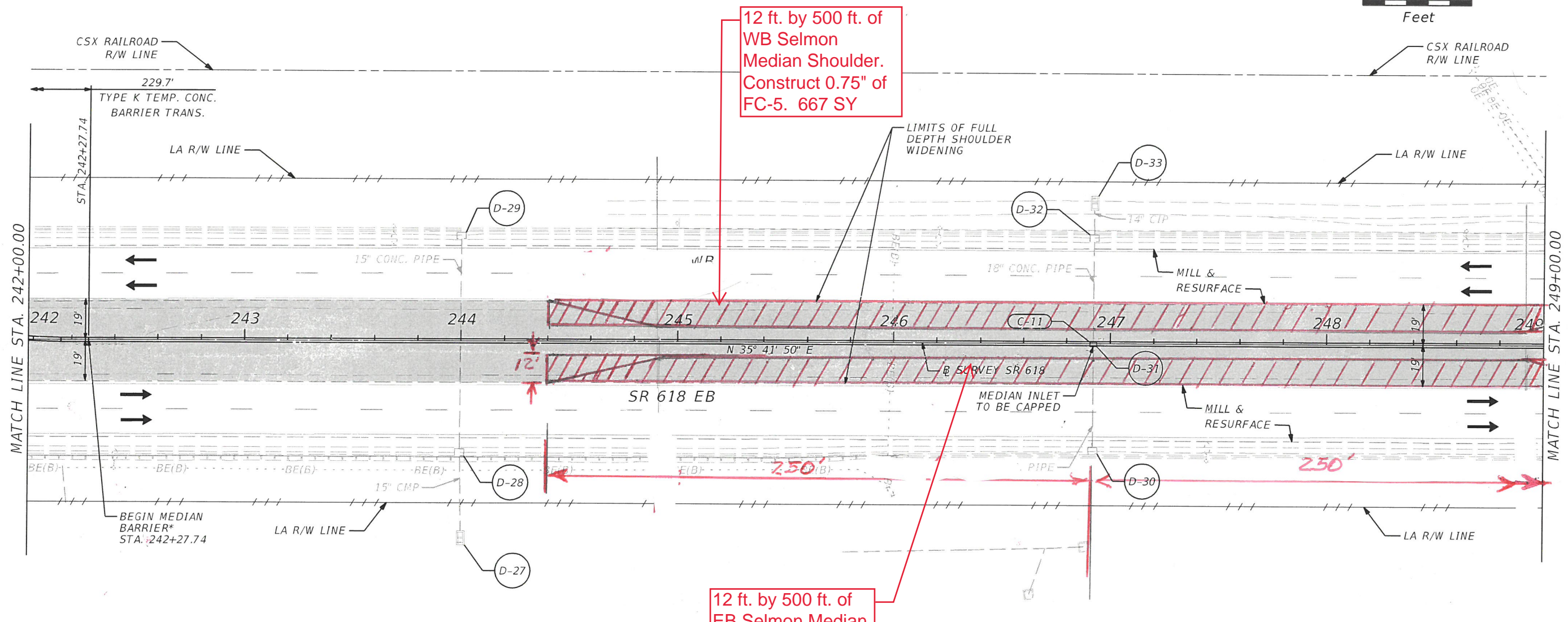
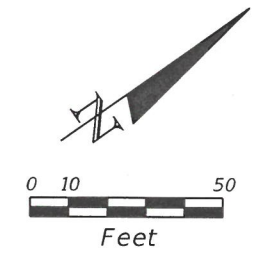

12 ft. by 500 ft. of WB Selmon Median Shoulder. Construct 0.75" of FC-5. 667 SY

12 ft. by 500 ft. of EB Selmon Median Shoulder. Construct 0.75" of FC-5. 667 SY

- LEGEND**
- DENOTES WIDENING
 - DENOTES PAVE. TRANS.
 - DENOTES MISC. PAVT.
 - DENOTES DIRECTION OF TRAFFIC
 - EXISTING DRAINAGE
 - PROPOSED STRUCTURE

NOTE:
 *SHORT GRADE-SEPARATED SECTION
 SPI 521-001 (SHEET 5 OF 21)

REVISIONS				BRIAN J. FLYNN, P.E. P.E. LICENSE NO. 48071 PARSONS TRANSPORTATION GROUP INC. 5100 W. LEMON STREET, SUITE 145 TAMPA, FL 33609 PHONE: (813) 933-3820 CERTIFICATE OF AUTHORIZATION NO. 1838	TAMPA HILLSBOROUGH EXPRESSWAY AUTHORITY			SHEET NO. 56
DATE	DESCRIPTION	DATE	DESCRIPTION		ROAD NO.	COUNTY	THEA PROJECT #	
					SR 618	HILLSBOROUGH	O-00518	

THE OFFICIAL RECORD OF THIS SHEET IS THE ELECTRONIC FILE DIGITALLY SIGNED AND SEALED UNDER RULE 61G15-23.004, F.A.C.

SWANN AVENUE TO PLATT STREET (2)

@ SURVEY SR 618 17
 PI STA. = 505+05.59
 Δ = 55° 11' 33" (RT.)
 D = 4° 00' 00"
 T = 748.72
 L = 1,379.81
 R = 1,432.39
 PC STA. = 497+56.87
 PT STA. = 511+36.68
 e = 0.083

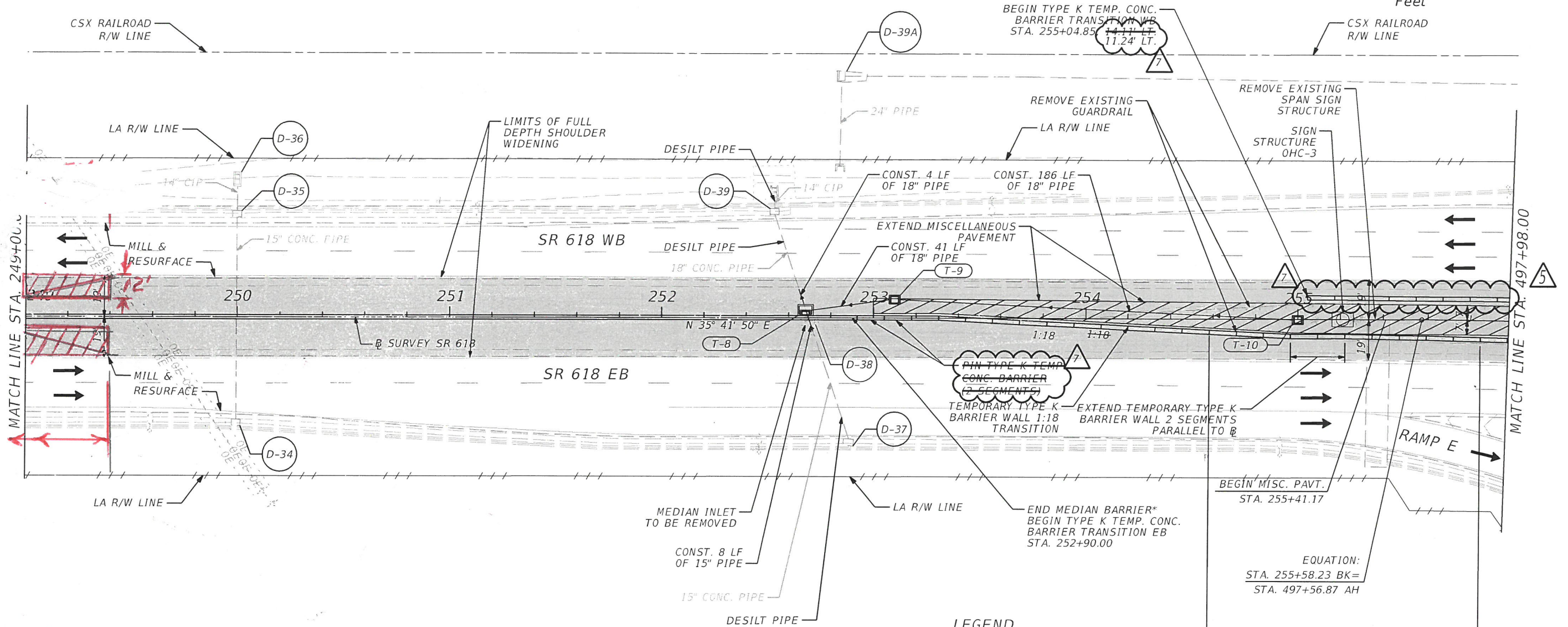
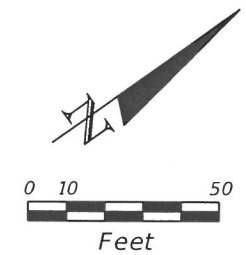

MATCH LINE STA. 249+00.00

MATCH LINE STA. 497+98.00

NOTE:
 *SHORT GRADE-SEPARATED SECTION
 SPI 521-001 (SHEET 5 OF 21)

- LEGEND**
- DENOTES WIDENING
 - DENOTES PAVE. TRANS.
 - DENOTES MISC. PAVT.
 - DENOTES DIRECTION OF TRAFFIC
 - XX EXISTING DRAINAGE
 - XX PROPOSED STRUCTURE

TYPE K TEMP. CONC. BARRIER TRANSITION EB (ANCHOR PER SPI 102-110)

REVISIONS				TAMPA HILLSBOROUGH EXPRESSWAY AUTHORITY			ROADWAY PLAN	SHEET NO. 57
DATE	DESCRIPTION	DATE	DESCRIPTION	ROAD NO.	COUNTY	THEA PROJECT #		
06/30/20	Δ REVISED 2" MISCELLANEOUS PAVEMENT LIMITS AT BRIDGE ABUTMENTS			SR 618	HILLSBOROUGH	O-00518		
10/23/20	Δ AS-BUILT							

BRIAN J. FLYNN, P.E.
 P.E. LICENSE NO. 48071
 PARSONS TRANSPORTATION GROUP INC.
 5100 W. LEMON STREET, SUITE 145
 TAMPA, FL 33609
 PHONE: (813) 933-3820
 CERTIFICATE OF AUTHORIZATION NO. 1838

THE OFFICIAL RECORD OF THIS SHEET IS THE ELECTRONIC FILE DIGITALLY SIGNED AND SEALED UNDER RULE 61G15-23.004, F.A.C.