

**TAMPA-HILLSBOROUGH COUNTY
EXPRESSWAY AUTHORITY**

Addendum No. 1

FOR

Invitation to Bid (ITB)

FY22 Selmon Ramps & Misc. Mainline Resurfacing

ITB O-01221 and O-01321

Addendum No. 1 ~ ITB O-01221 and O-01321

Date of Addendum: August 31, 2021

Please note the following revisions to the subject RFP:

Attached updated set of resurfacing maps to replace sheet 12 of 26 with the correct information.

The attached file replaces the old 4.01.01_Resurfacing_Maps_081821.

Proposers MUST acknowledge receipt of this Addendum/Letter of Clarification by signing, dating and returning the completed Acknowledgement of Receipt of Addendum/Letter of Clarification form **with the Proposer's response package**.

All other items, conditions, and specifications in the procurement document not specifically changed by the Addendum/Letter of Clarification remain unchanged.

Please send all questions to THEA's Procurement Manager, Man Le, via email at Man.Le@tampa-xway.com.

ACKNOWLEDGEMENT OF RECEIPT OF ADDENDUM and/or LETTER OF CLARIFICATION

Were Addenda issued on this Solicitation?

Yes

No

Were Letter of Clarification issued on this Solicitation?

Yes

No

I (We) hereby acknowledge receipt of the following Addendum/Addenda issued in reference to this solicitation by listing the Addenda by number, date and signing the form:

Addendum _____ Date: _____

Addendum _____ Date: _____

Letter of Clarification _____ Date: _____

Letter of Clarification _____ Date: _____

PROPOSER:

By: _____

Authorized Signature

Printed Name of Signer

Title of Signer

Date Signed

[END OF ACKNOWLEDGMENT OF RECEIPT FORM]



**NO SHOULDER
MILLING AND
RESURFACING
FOR ALL
LOCATIONS
EXCEPT
FALKENBURG
ROAD RAMPS**

WEUCID AVE

WB SELMON EXPY

EB SELMON EXPY

END M&R
AT PAVEMENT JOINT

O-01221
EUCLID EB ON RAMP TO SELMON EXPY LANE
1.5" MILLING AND RESURFACING
1226 SY

BEGIN M&R
AT PAVEMENT JOINT

S DREXEL AVE

S WAVERLY CIRCLE



WB SELMON EXPY

EB SELMON EXPY

BAY TO BAY BLVD

BEGIN M&R
AT PAVEMENT JOINT

END M&R
AT PAVEMENT JOINT

O-01221
BAY TO BAY EB ON RAMP TO SELMON EXPY LANE
1.5" MILLING AND RESURFACING
1133 SY



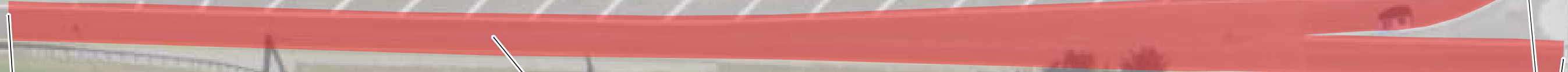
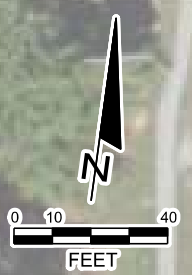

BEGIN M&R
AT PAVEMENT JOINT

O-01221
50TH ST WB ON RAMP TO SELMON EXPY LANE
1.5" MILLING AND RESURFACING
1839 SY

END M&R
AT CROSSWALKS

WB SELMON EXPY

SELMON EXPY REVERSIBLE LANES

EB SELMON EXPY



**BEGIN M&R AT
PAVEMENT JOINT
TO ROUGH PATCH**

SELMON EXPY REVERSIBLE LANES

**END M&R 100 FEET
EAST OF START POINT**

WB SELMON EXPY

**O-01221
WB SELMON EXPY LOCAL LANES FROM PAVEMENT JOINT
TO POINT 100 FEET EAST
3" MILLING AND RESURFACING
283 SY**

EB SELMON EXPY

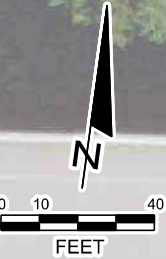

O-01221
WB SELMON EXPY LOCAL LANES
RESURFACE WB ROADWAY TRAVEL LANES 50 FEET WEST
AND 50 FEET EAST OF CENTER OF EXISTING PATCH LOCATED
APPROXIMATELY AT PIER 97



100 FT

O-01221
WB SELMON EXPY LOCAL LANES
3" MILLING AND RESURFACING
435 SY

SELMON EXPY REVERSIBLE LANES

WB SELMON EXPY

EB SELMON EXPY



An aerial photograph of a multi-lane highway bridge. The bridge has several travel lanes in each direction. A red double-headed arrow is drawn across the roadway, indicating a specific section. To the right of the bridge, there is a large industrial yard filled with numerous colorful shipping containers, some stacked high. There are also several semi-trucks and other vehicles parked in the yard. A large building with a corrugated metal roof is visible in the lower right. A north arrow is located in the bottom right corner of the image.

Resurface WB Roadway travel lanes below the Reversible Express Lanes 50 feet west and 50 feet east of center of existing patch located approximately at Pier 97

Straddle Bent Pier No. 97

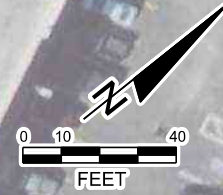

WEST

BEGIN M&R
AT STOP BAR

END M&R
AT PAVEMENT JOINT

E KENNEDY BLVD

O-01321
KENNEDY WB OFF RAMP LANE
3" MILLING AND RESURFACING
TOP 1.5" TO BE HI-POLYMER
946 SY

WB SELMON EXPY

EB SELMON EXPY

N GOVERNOR ST

E KENNEDY BLVD



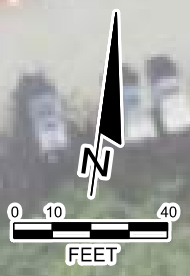

WB SELMON EXPY

SELMON EXPY REVERSIBLE LANES

EB SELMON EXPY

O-01321
EB SELMON EXPY LOCAL LANES FROM PIER 65 TO MAYDELL BRIDGE APPROACH SLAB
3" MILLING AND RESURFACING
4288 SY

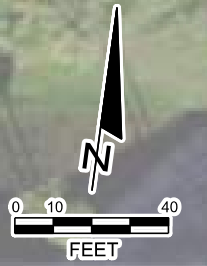

WB SELMON EXPY

SELMON EXPY REVERSIBLE LANES

EB SELMON EXPY

END M&R
AT PAVEMENT JOINT

O-01321
EB SELMON EXPY LOCAL LANES FROM PIER 65 TO MAYDELL BRIDGE APPROACH SLAB
3" MILLING AND RESURFACING
4288 SY

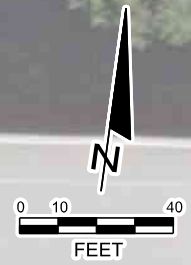

SELMON EXPY REVERSIBLE LANES

WB SELMON EXPY

EB SELMON EXPY

BEGIN M&R AT PAVEMENT JOINT

O-01321
EB SELMON EXPY LOCAL LANES FROM PIER 94 TO BRIDGE APPROACH SLAB
3" MILLING AND RESURFACING
8262 SY

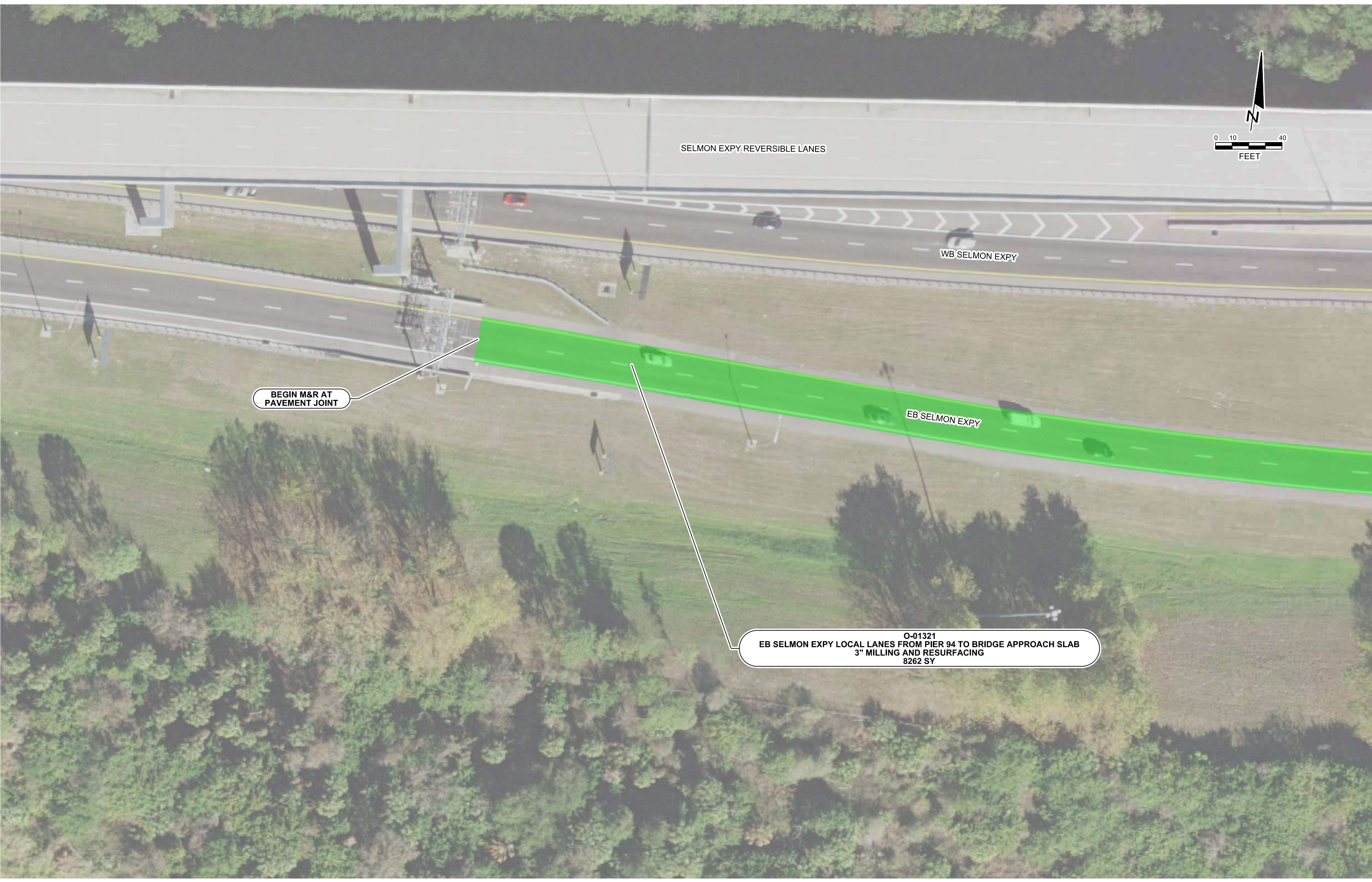

SELMON EXPY REVERSIBLE LANES

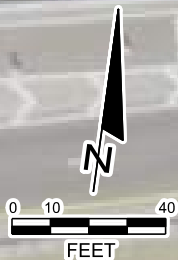

WB SELMON EXPY

EB SELMON EXPY

O-01321
EB SELMON EXPY LOCAL LANES FROM PIER 94 TO BRIDGE APPROACH SLAB
3" MILLING AND RESURFACING
8262 SY



SELMON EXPY REVERSIBLE LANES

WB SELMON EXPY

EB SELMON EXPY

O-01321
EB SELMON EXPY LOCAL LANES FROM PIER 94 TO BRIDGE APPROACH SLAB
3" MILLING AND RESURFACING
8262 SY



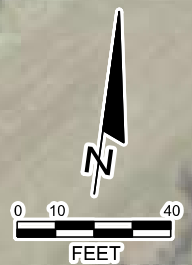

WB SELMON EXPY

SELMON EXPY REVERSIBLE LANES

EB SELMON EXPY

END M&R AT PAVEMENT JOINT

O-01321
EB SELMON EXPY LOCAL LANES FROM PIER 94 TO BRIDGE APPROACH SLAB
3" MILLING AND RESURFACING
8262 SY





SB 78TH ST

NB 78TH ST

BEGIN M&R AT PAVEMENT JOINT

END M&R AT PAVEMENT JOINT

O-01321
78TH ST WB ON RAMP FROM SR 60 LANE
1.5" MILLING AND RESURFACING
1250 SY

O-01321
78TH ST WB ON RAMP LANE
3" MILLING AND RESURFACING
TOP 1.5" TO BE HI-POLYMER
2940 SY

WB SELMON EXPY

SELMON EXPY REVERSIBLE LANES

EB SELMON EXPY



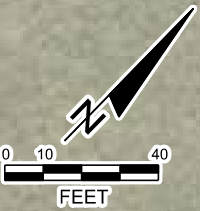

WB SR60

EB SR60

END M&R AT
PAVEMENT JOINT

O-01321
78TH ST WB ON RAMP FROM SR 60 LANE
1.5" MILLING AND RESURFACING
1250 SY



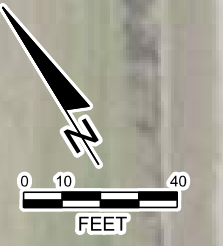

NB 78TH ST
SB 78TH ST

BEGIN M&R AT
PAVEMENT JOINT

O-01321
78TH ST OFF RAMP EB LANE
1.5" MILLING AND RESURFACING
289 SY

END M&R AT
PAVEMENT JOINT





US301 N ON RAMP TO WB SELMON EXPY

WB SELMON EXPY

SELMON EXPY REVERSIBLE LANES

EB SELMON EXPY

EB SELMON EXPY
EXIT TO US 301

BEGIN M&R AT
PAINTED GORE

END M&R AT
END OF GORE

O-01321
EB OFF EXIT TO US 301 LANE
1.5" MILLING AND RESURFACING
489 SY

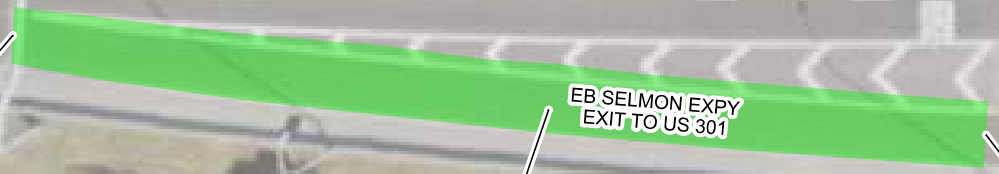

**NO SHOULDER
MILLING AND
RESURFACING
FOR ALL
LOCATIONS
EXCEPT
FALKENBURG
ROAD RAMPS**

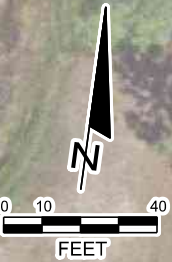

O-01321
FALKENBURG WB ON RAMP LANE AND SHOULDERS
1.5" MILLING AND RESURFACING
3113 SY

BEGIN M&R AT
END OF GORE

S FALKENBURG RD ON RAMP TO WB SELMON EXPY

WB SELMON EXPY

SELMON EXPY REVERSIBLE LANES

EB SELMON EXPY



**NO SHOULDER
MILLING AND
RESURFACING
FOR ALL
LOCATIONS
EXCEPT
FALKENBURG
ROAD RAMPS**

END M&R AT
PAVEMENT JOINT

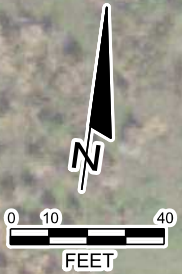

SB FALKENBURG RD

NB FALKENBURG RD

O-01321
FALKENBURG WB ON RAMP LANE AND SHOULDERS
1.5" MILLING AND RESURFACING
3113 SY

END M&R AT
PAVEMENT JOINT

WB SELMON EXPY

BETWEEN HIMES AND EUCLID AVENUES (1)

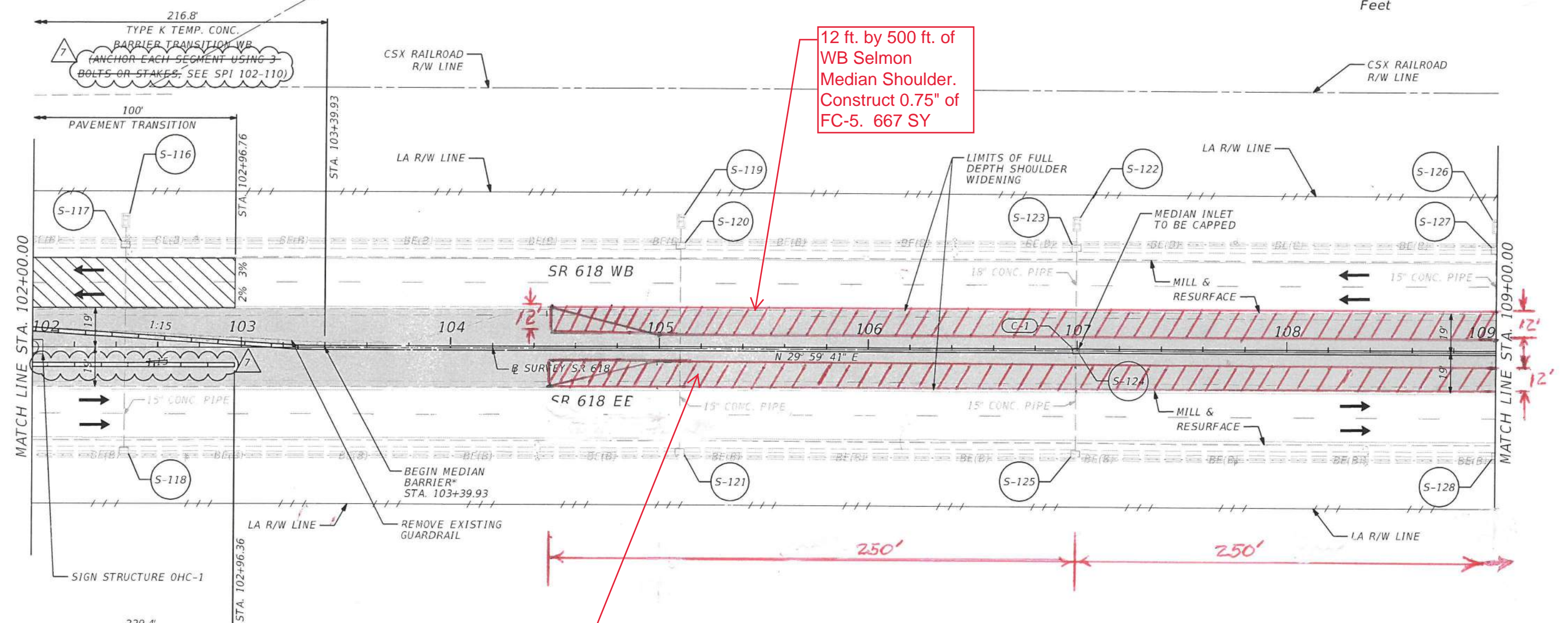
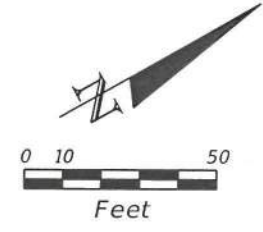

12 ft. by 500 ft. of
WB Selmon
Median Shoulder.
Construct 0.75" of
FC-5. 667 SY

12 ft. by 500 ft. of
EB Selmon Median
Shoulder.
Construct 0.75" of
FC-5. 667 SY

LEGEND

- DENOTES WIDENING
- DENOTES PAVE. TRANS.
- DENOTES MISC. PAVT.
- DENOTES DIRECTION OF TRAFFIC
- XX EXISTING DRAINAGE
- XX PROPOSED STRUCTURE

NOTE:
*SHORT GRADE-SEPARATED SECTION
SPI 521-001 (SHEET 5 OF 21)

REVISIONS		BRIAN J. FLYNN, P.E. P.E. LICENSE NO. 48071 PARSONS TRANSPORTATION GROUP INC. 5100 W. LEMON STREET, SUITE 145 TAMPA, FL 33609 PHONE: (813) 933-3820 CERTIFICATE OF AUTHORIZATION NO. 1838		TAMPA HILLSBOROUGH EXPRESSWAY AUTHORITY			ROADWAY PLAN	SHEET NO. 36
DATE	DESCRIPTION	DATE	DESCRIPTION	ROAD NO.	COUNTY	THEA PROJECT #		
10/23/26	AS-BUILT			SR 618	HILLSBOROUGH	O-00518		

THE OFFICIAL RECORD OF THIS SHEET IS THE ELECTRONIC FILE DIGITALLY SIGNED AND SEALED UNDER RULE 61G15-23.004, F.A.C.

BETWEEN HIMES AND EUCLID AVENUES (2)

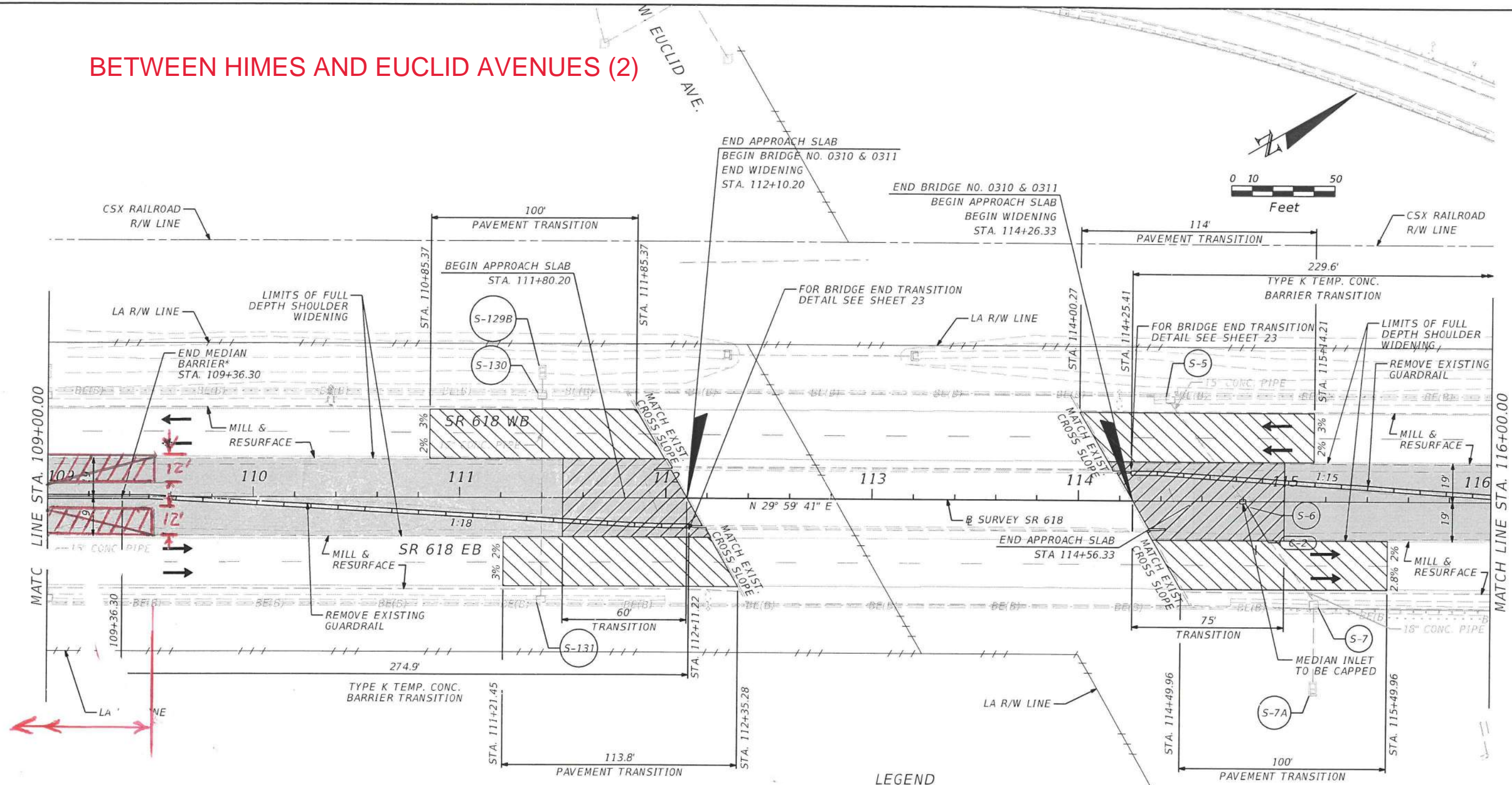

NOTE:
 *SHORT GRADE-SEPARATED SECTION
 SPI 521-001 (SHEET 5 OF 21)

LEGEND

- DENOTES WIDENING
- DENOTES PAVE. TRANS.
- DENOTES MISC. PAVT.
- DENOTES DIRECTION OF TRAFFIC
- XX EXISTING DRAINAGE
- XX PROPOSED STRUCTURE

REVISIONS			
DATE	DESCRIPTION	DATE	DESCRIPTION

BRIAN J. FLYNN, P.E.
 P.E. LICENSE NO. 48071
 PARSONS TRANSPORTATION GROUP INC.
 5100 W. LEMON STREET, SUITE 145
 TAMPA, FL 33609
 PHONE: (813) 933-3820
 CERTIFICATE OF AUTHORIZATION NO. 1838

TAMPA HILLSBOROUGH EXPRESSWAY AUTHORITY		
ROAD NO.	COUNTY	THEA PROJECT #
SR 618	HILLSBOROUGH	O-00518

ROADWAY PLAN

SHEET NO.
37

THE OFFICIAL RECORD OF THIS SHEET IS THE ELECTRONIC FILE DIGITALLY SIGNED AND SEALED UNDER RULE 61G15-23.004, F.A.C.

MISSISSIPPI AVENUE TO S. HOWARD AVENUE (1)

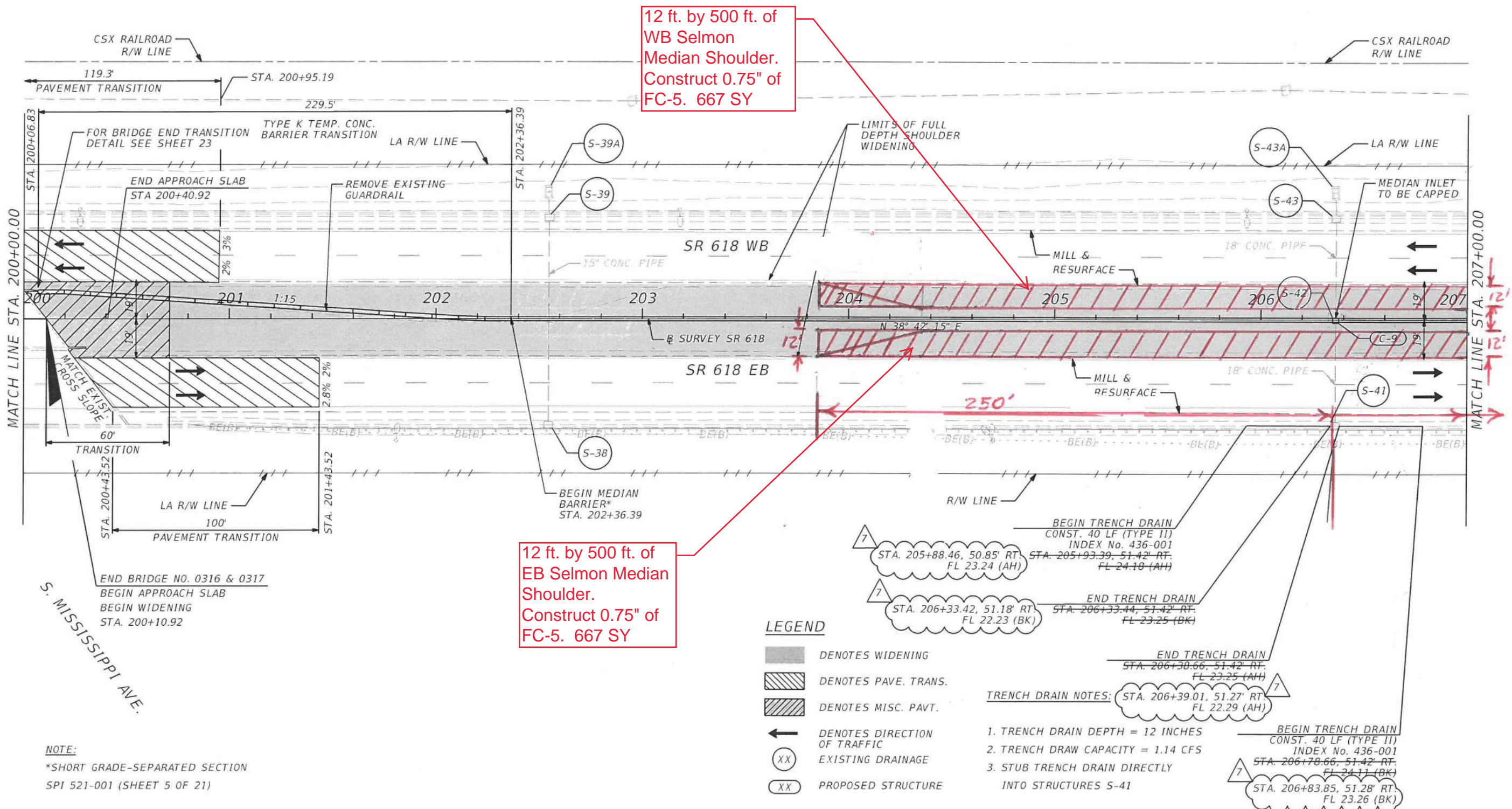
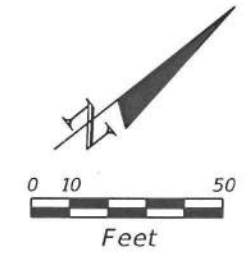

NOTE:
 *SHORT GRADE-SEPARATED SECTION
 SPI 521-001 (SHEET 5 OF 21)

LEGEND

- DENOTES WIDENING
- DENOTES PAVE. TRANS.
- DENOTES MISC. PAVT.
- DENOTES DIRECTION OF TRAFFIC
- XX EXISTING DRAINAGE
- XX PROPOSED STRUCTURE

TRENCH DRAIN NOTES:

1. TRENCH DRAIN DEPTH = 12 INCHES
2. TRENCH DRAIN CAPACITY = 1.14 CFS
3. STUB TRENCH DRAIN DIRECTLY INTO STRUCTURES S-41

BEGIN TRENCH DRAIN
 CONST. 40 LF (TYPE II)
 INDEX No. 436-001
 STA. 205+88.46, 50.85' RT. FL 23.24 (AH)
 STA. 205+93.39, 51.42' RT. FL 24.18 (AH)

END TRENCH DRAIN
 STA. 206+33.42, 51.18' RT. FL 22.23 (BK)
 STA. 206+33.44, 51.42' RT. FL 23.25 (BK)

END TRENCH DRAIN
 STA. 206+39.01, 51.27' RT. FL 22.29 (AH)

BEGIN TRENCH DRAIN
 CONST. 40 LF (TYPE II)
 INDEX No. 436-001
 STA. 206+78.66, 51.42' RT. FL 24.11 (BK)
 STA. 206+83.85, 51.28' RT. FL 23.26 (BK)

DATE		REVISIONS		DESCRIPTION	BRIAN J. FLYNN, P.E. P.E. LICENSE NO. 48071 PARSONS TRANSPORTATION GROUP INC. 5100 W. LEMON STREET, SUITE 145 TAMPA, FL 33609 PHONE: (813) 933-3820 CERTIFICATE OF AUTHORIZATION NO. 1838	TAMPA HILLSBOROUGH EXPRESSWAY AUTHORITY			SHEET NO.	
DATE	DESCRIPTION	DATE	DESCRIPTION			ROAD NO.	COUNTY	THEA PROJECT #		
10/23/20	AS-BUILT					SR 618	HILLSBOROUGH	O-00518	ROADWAY PLAN	50

THE OFFICIAL RECORD OF THIS SHEET IS THE ELECTRONIC FILE DIGITALLY SIGNED AND SEALED UNDER RULE 61G15-23.004, F.A.C.

MISSISSIPPI AVENUE TO S. HOWARD AVENUE (2)

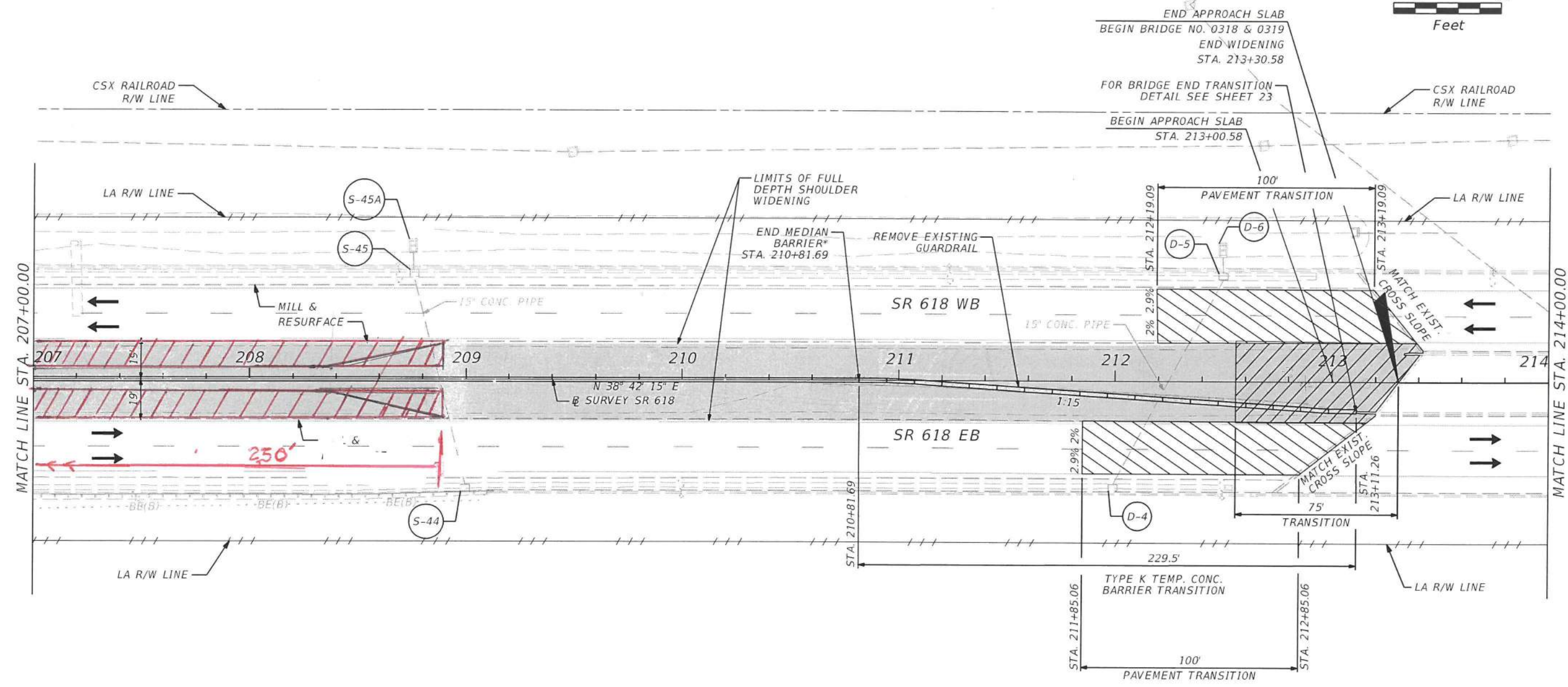
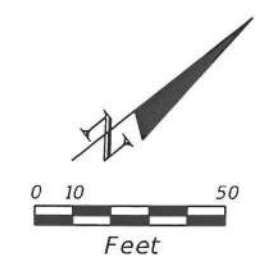

- LEGEND**
- DENOTES WIDENING
 - DENOTES PAVE. TRANS.
 - DENOTES MISC. PAVT.
 - DENOTES DIRECTION OF TRAFFIC
 - EXISTING DRAINAGE
 - PROPOSED STRUCTURE

NOTE:
 *SHORT GRADE-SEPARATED SECTION
 SPI 521-001 (SHEET 5 OF 21)

DATE		REVISIONS		BRIAN J. FLYNN, P.E. P.E. LICENSE NO. 48071 PARSONS TRANSPORTATION GROUP INC. 5100 W. LEMON STREET, SUITE 145 TAMPA, FL 33609 PHONE: (813) 933-3820 CERTIFICATE OF AUTHORIZATION NO. 1838	TAMPA HILLSBOROUGH EXPRESSWAY AUTHORITY			<h2 style="margin: 0;">ROADWAY PLAN</h2>	SHEET NO. 51
		DESCRIPTION	DATE		DESCRIPTION	ROAD NO.	COUNTY		
						SR 618	HILLSBOROUGH		

THE OFFICIAL RECORD OF THIS SHEET IS THE ELECTRONIC FILE DIGITALLY SIGNED AND SEALED UNDER RULE 61G15-23.004, F.A.C.

MORRISON AVENUE TO SWANN AVENUE

SURVEY SR 618.14
 PI STA. = 236+72.15
 Δ = 3° 00' 25" (LT.)
 D = 0° 29' 56"
 T = 301.43
 L = 602.71
 R = 11,484.19
 PC STA. = 233+70.72
 PT STA. = 239+73.44
 e = NC

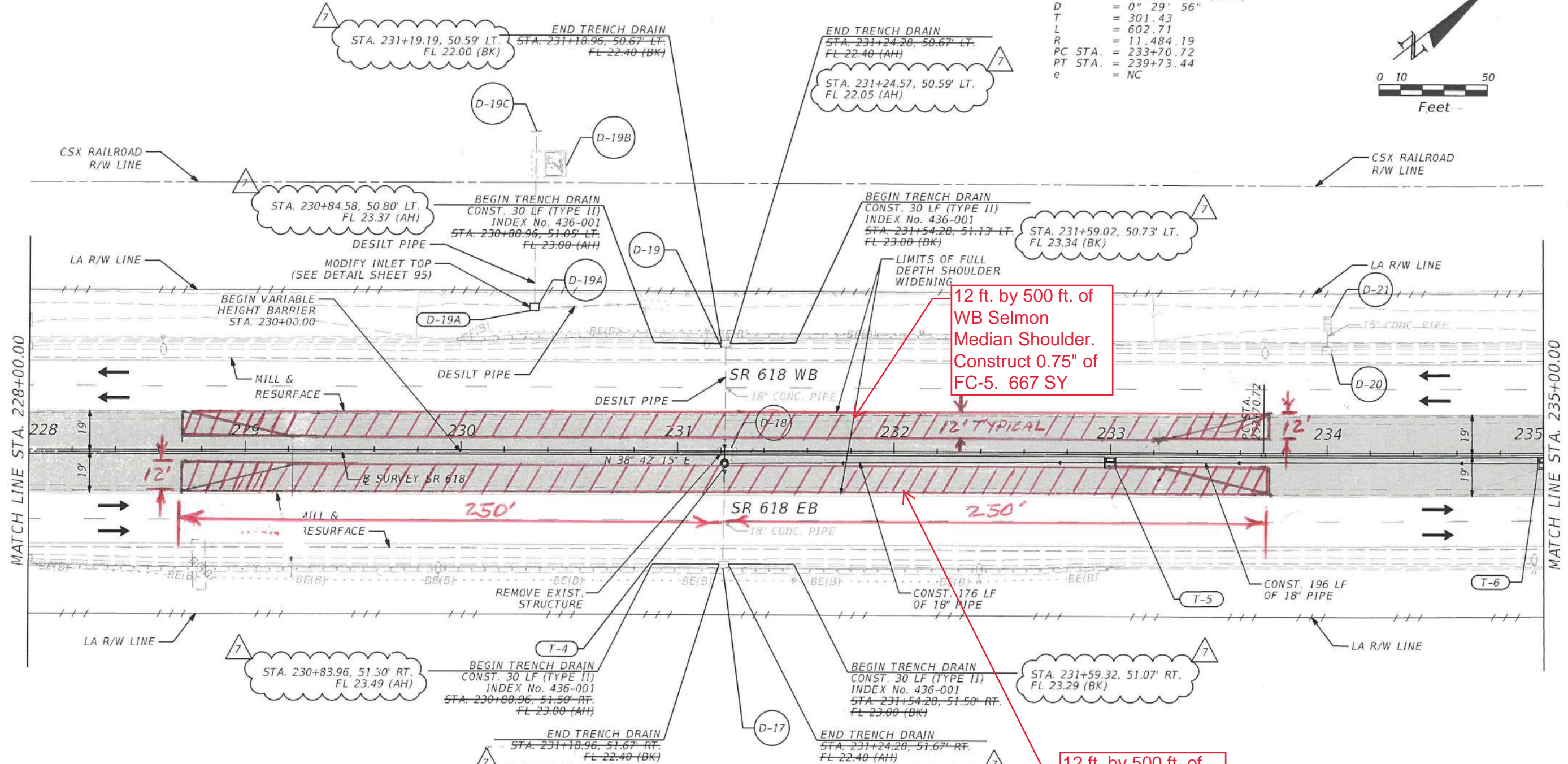
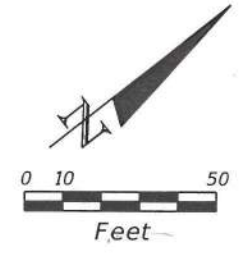

12 ft. by 500 ft. of
 WB Selmon
 Median Shoulder.
 Construct 0.75" of
 FC-5. 667 SY

12 ft. by 500 ft. of
 EB Selmon Median
 Shoulder.
 Construct 0.75" of
 FC-5. 667 SY

- TRENCH DRAIN NOTES:**
- TRENCH DRAIN DEPTH = 12 INCHES
 - TRENCH DRAIN CAPACITY = 1.14 CFS
 - STUB TRENCH DRAIN DIRECTLY INTO STRUCTURES D-17 & D-19

- LEGEND**
- DENOTES WIDENING
 - DENOTES PAVE. TRANS.
 - DENOTES MISC. PAVT.
 - DENOTES DIRECTION OF TRAFFIC
 - EXISTING DRAINAGE
 - PROPOSED STRUCTURE

REVISIONS		BRIAN J. FLYNN, P.E. P.E. LICENSE NO. 48071 PARSONS TRANSPORTATION GROUP INC. 5100 W. LEMON STREET, SUITE 145 TAMPA, FL 33609 PHONE: (813) 933-3820 CERTIFICATE OF AUTHORIZATION NO. 1838	TAMPA HILLSBOROUGH EXPRESSWAY AUTHORITY		SHEET NO. 54
DATE	DESCRIPTION		ROAD NO.	THEA PROJECT #	
10/23/20	AS-BUILT		SR 618	0-00518	

THE OFFICIAL RECORD OF THIS SHEET IS THE ELECTRONIC FILE DIGITALLY SIGNED AND SEALED UNDER RULE 61G15-23.004, F.A.C.

SWANN AVENUE TO PLATT STREET (1)

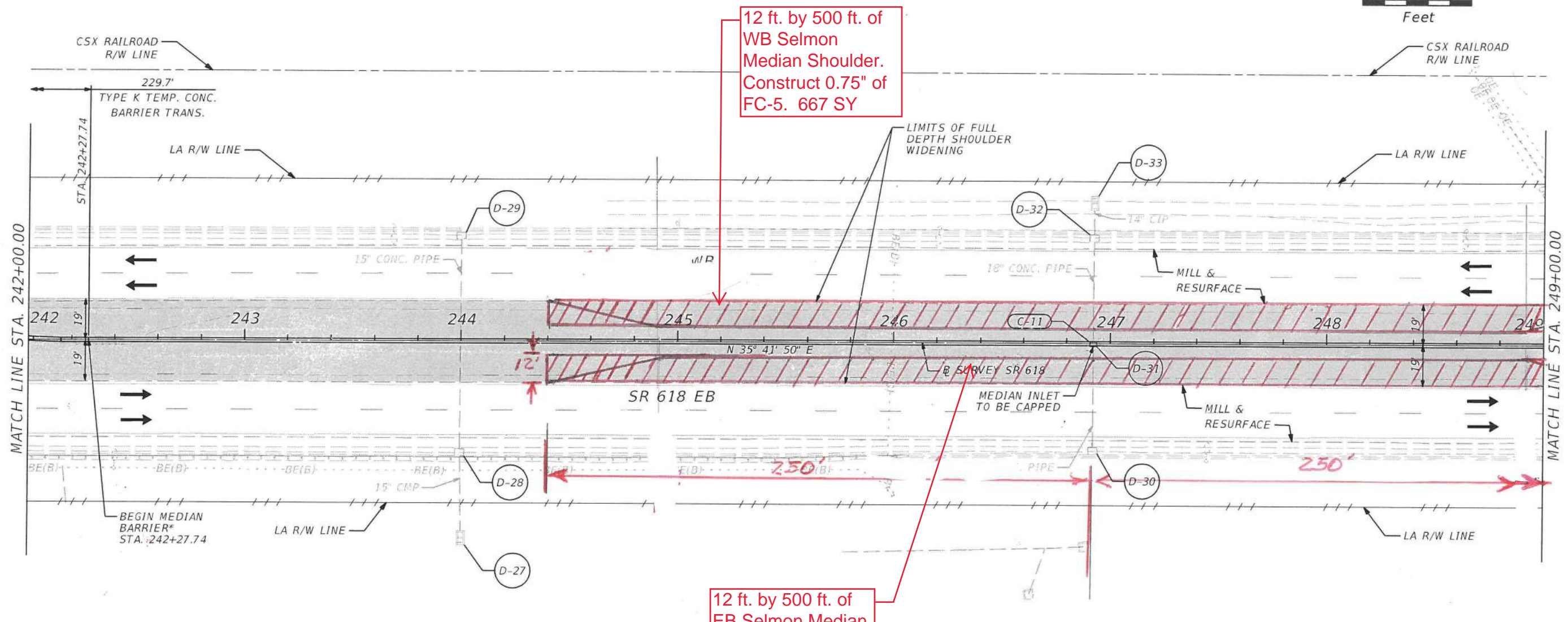
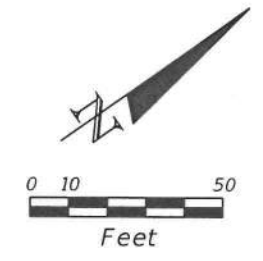

12 ft. by 500 ft. of WB Selmon Median Shoulder. Construct 0.75\"/>

12 ft. by 500 ft. of EB Selmon Median Shoulder. Construct 0.75\"/>

- LEGEND**
- DENOTES WIDENING
 - DENOTES PAVE. TRANS.
 - DENOTES MISC. PAVT.
 - DENOTES DIRECTION OF TRAFFIC
 - EXISTING DRAINAGE
 - PROPOSED STRUCTURE

NOTE:
 *SHORT GRADE-SEPARATED SECTION
 SPI 521-001 (SHEET 5 OF 21)

REVISIONS		BRIAN J. FLYNN, P.E. P.E. LICENSE NO. 48071 PARSONS TRANSPORTATION GROUP INC. 5100 W. LEMON STREET, SUITE 145 TAMPA, FL 33609 PHONE: (813) 933-3820 CERTIFICATE OF AUTHORIZATION NO. 1838	TAMPA HILLSBOROUGH EXPRESSWAY AUTHORITY		SHEET NO. 56
DATE	DESCRIPTION		ROAD NO.	COUNTY	
			SR 618	HILLSBOROUGH	O-00518

THE OFFICIAL RECORD OF THIS SHEET IS THE ELECTRONIC FILE DIGITALLY SIGNED AND SEALED UNDER RULE 61G15-23.004, F.A.C.

SWANN AVENUE TO PLATT STREET (2)

@ SURVEY SR 618.17
 PI STA. = 505+05.59
 Δ = 55° 11' 33" (RT.)
 D = 4° 00' 00"
 T = 748.72
 L = 1,379.81
 R = 1,432.39
 PC STA. = 497+56.87
 PT STA. = 511+36.68
 e = 0.083

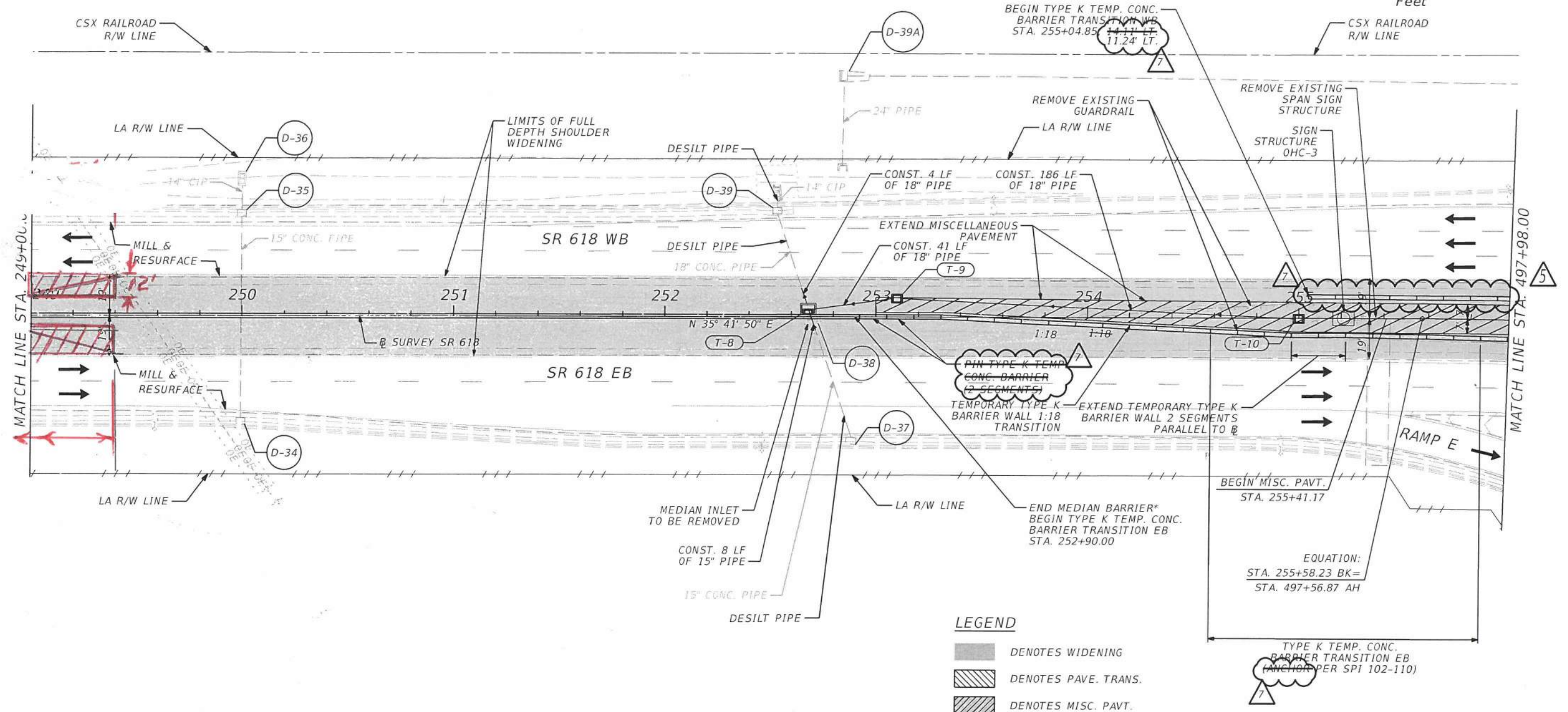
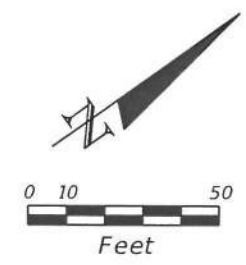

NOTE:
 *SHORT GRADE-SEPARATED SECTION
 SPI 521-001 (SHEET 5 OF 21)

- LEGEND**
- DENOTES WIDENING
 - DENOTES PAVE. TRANS.
 - DENOTES MISC. PAVT.
 - DENOTES DIRECTION OF TRAFFIC
 - EXISTING DRAINAGE
 - PROPOSED STRUCTURE

TYPE K TEMP. CONC. BARRIER TRANSITION EB (ANCHOR PER SPI 102-110)

REVISIONS				TAMPA HILLSBOROUGH EXPRESSWAY AUTHORITY			SHEET NO.
DATE	DESCRIPTION	DATE	DESCRIPTION	ROAD NO.	COUNTY	THEA PROJECT #	
06/30/20	Δ REVISED 2" MISCELLANEOUS PAVEMENT LIMITS AT BRIDGE ABUTMENTS			SR 618	HILLSBOROUGH	O-00518	57
10/23/20	Δ AS-BUILT						

BRIAN J. FLYNN, P.E.
 P.E. LICENSE NO. 48071
 PARSONS TRANSPORTATION GROUP INC.
 5100 W. LEMON STREET, SUITE 145
 TAMPA, FL 33609
 PHONE: (813) 933-3820
 CERTIFICATE OF AUTHORIZATION NO. 1838

THE OFFICIAL RECORD OF THIS SHEET IS THE ELECTRONIC FILE DIGITALLY SIGNED AND SEALED UNDER RULE 61G15-23.004, F.A.C.